

# GREENLINE 40

Lady Elma (2022)



Pollen Maritime AS • Martin Linges Vei 25 • Fornebu • Norway

Phone: +47 41 197 474

E-mail: [booking@holiday-yacht-charter.com](mailto:booking@holiday-yacht-charter.com)

Web: [holiday-yacht-charter.com](http://holiday-yacht-charter.com)

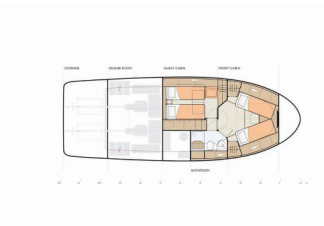

Yacht Base	Marina Kornati, Biograd, Croatia
Yacht ID	3477
Yacht Brands	Greenline
Yacht Name	Lady Elma
Production Year	2022
Length	11.99 M
Cabins	2
Berths	4 + 2
Persons	6
WC/Shower	1

**COMFORT:** Cockpit cushions, Sundeck cushions

**DECK:** Anchor with chain, Bathing platform, Cockpit table, Cockpit/stern, outside shower, Dinghy, Electric anchor windlass, Fenders, Main anchor, Main Deck Compass, Mooring ropes , Sea/Storm drogue anchor, Sun roof, Swimming ladder, Teak cockpit, Teak seats in cockpit

**ENTERTAINMENT:** Audio pack, Bluetooth player, LCD TV, Outdoor speakers, Radio, USB, Bluetooth, Remote control for radio in cockpit, Underwater lights

**GALLEY:** Dishwasher, Freezer, Hot water, Induction hot plate, Microwave, Refrigerator

**INTERIOR:** Ambiantal lighting, Electric toilet

**NAVIGATION:** Autopilot, Bow thruster, GPS chart plotter, Hand bearing compass, Harbour guides, Hydraulic flaps, Navigation (Nautical) charts and nautical guide , Stern thruster

**SAFETY:** Black Water Tank, Fire extinguisher , First aid kit , Fog horn, Life jackets, Set of tools , Signal rockets and torches , Torch

**YACHT ELECTRICS:** 12V Socket, 230 volt socket, Air Conditioning, Batteries, Electricity 230VAC, Heating, Inverter, Shore connection 220 V, Solar panels

## PRICE AND AVAILABILITY

Greenline 40 Lady Elma (2022)



<b>01.01. - 28.02.2025</b> Not available	<b>01.03. - 08.03.2025</b> 2.720 € <del>3.400€</del>	<b>08.03. - 15.03.2025</b> 2.720 € <del>3.400€</del>	<b>15.03. - 22.03.2025</b> 2.720 € <del>3.400€</del>
<b>22.03. - 29.03.2025</b> 2.720 € <del>3.400€</del>	<b>29.03. - 05.04.2025</b> 2.720 € <del>3.400€</del>	<b>05.04. - 12.04.2025</b> 2.720 € <del>3.400€</del>	<b>12.04. - 19.04.2025</b> 2.720 € <del>3.400€</del>
<b>19.04. - 26.04.2025</b> 2.720 € <del>3.400€</del>	<b>26.04. - 03.05.2025</b> 2.720 € <del>3.400€</del>	<b>03.05. - 10.05.2025</b> 2.720 € <del>3.400€</del>	<b>10.05. - 17.05.2025</b> 3.040 € <del>3.800€</del>
<b>17.05. - 24.05.2025</b> 3.200 € <del>4.000€</del>	<b>24.05. - 31.05.2025</b> 3.520 € <del>4.400€</del>	<b>31.05. - 07.06.2025</b> Not available	<b>07.06. - 14.06.2025</b> 4.160 € <del>5.200€</del>
<b>14.06. - 21.06.2025</b> 4.320 € <del>5.400€</del>	<b>21.06. - 28.06.2025</b> Not available	<b>28.06. - 05.07.2025</b> 4.640 € <del>5.800€</del>	

## PRICE AND AVAILABILITY

Greenline 40 Lady Elma (2022)



<b>05.07. - 12.07.2025</b> 4.800 € <del>6.000€</del>	<b>12.07. - 19.07.2025</b> 4.960 € <del>6.200€</del>	<b>19.07. - 26.07.2025</b> 4.960 € <del>6.200€</del>	<b>26.07. - 02.08.2025</b> Not available
<b>02.08. - 09.08.2025</b> 4.800 € <del>6.000€</del>	<b>09.08. - 16.08.2025</b> 4.640 € <del>5.800€</del>	<b>16.08. - 23.08.2025</b> 4.480 € <del>5.600€</del>	<b>23.08. - 30.08.2025</b> 4.160 € <del>5.200€</del>
<b>30.08. - 06.09.2025</b> 4.160 € <del>5.200€</del>	<b>06.09. - 13.09.2025</b> 3.840 € <del>4.800€</del>	<b>13.09. - 20.09.2025</b> 3.520 € <del>4.400€</del>	<b>20.09. - 27.09.2025</b> 3.040 € <del>3.800€</del>
<b>27.09. - 04.10.2025</b> 2.720 € <del>3.400€</del>	<b>04.10. - 11.10.2025</b> 2.720 € <del>3.400€</del>	<b>11.10. - 18.10.2025</b> 2.720 € <del>3.400€</del>	<b>18.10. - 25.10.2025</b> 2.720 € <del>3.400€</del>
<b>26.10. - 31.12.2025</b> Not available			