

# SUN ODYSSEY 380

Philippa (2023)



Pollen Maritime AS • Martin Linges Vei 25 • Fornebu • Norway

Phone: +47 41 197 474

E-mail: [booking@holiday-yacht-charter.com](mailto:booking@holiday-yacht-charter.com)

Web: [holiday-yacht-charter.com](http://holiday-yacht-charter.com)

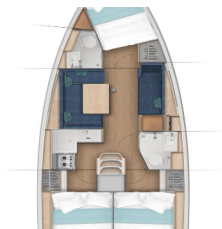

Yacht Base	Procida, Italy
Yacht ID	11684
Yacht Brands	Jeanneau
Yacht Name	Philippa
Production Year	2023
Length	11.22 M
Cabins	3
Berths	6 + 2
WC/Shower	2

**COMFORT:** Bed linen, Blankets, Cockpit cushions, Pillows, Towels

**DECK:** Anchor with chain, Bilge pump - Mechanic, Bimini top, Boat hook, Bosun's chair (Safe seat) (boatswain's chair), Cockpit/stern, outside shower, Deck brush, Electric anchor windlass, Fenders, Fuel funnel, Gangway, Mooring ropes , Plastic bucket, Spare anchor (Reserve, Auxiliary anchor), Sprayhood, Swimming ladder, Tender, Water hose, Winch handles

**ENTERTAINMENT:** CD player, Fins, Outdoor speakers

**GALLEY:** Coffee machine, Gas bottles, Hot water, Kitchen utensils (Galley equipment, cutlery), Oven, Refrigerator, Stove

**INTERIOR:** Barometer, Clock, Table

**NAVIGATION:** Autopilot, Binoculars, Bow thruster, Compass, Echosounder/Depthsounder, GPS chart plotter, Hand bearing compass, Log, Pilot book, Radar reflector, Wind instrument/Anemometer

**SAFETY:** Buoyant smoke signal, Distress flare box, Emergency tiller, Fire extinguisher , First aid kit , Fog horn, Horseshoe lifebuoy, Life belts (Safety harness), Life jackets, Liferaft , Repair kit, Torch, VHF radio

**YACHT ELECTRICS:** Battery charger , Bilge pump - Electric, Shore power cable

# PRICE AND AVAILABILITY

Sun Odyssey 380 Philippa (2023)



<b>11.01. - 18.01.2025</b> 2.008 € 2.350€	<b>18.01. - 25.01.2025</b> 2.008 € 2.350€	<b>25.01. - 01.02.2025</b> 2.008 € 2.350€	<b>01.02. - 08.02.2025</b> 2.008 € 2.350€
<b>08.02. - 15.02.2025</b> 2.008 € 2.350€	<b>15.02. - 22.02.2025</b> 2.008 € 2.350€	<b>22.02. - 01.03.2025</b> 2.008 € 2.350€	<b>01.03. - 08.03.2025</b> 2.008 € 2.350€
<b>08.03. - 15.03.2025</b> 2.008 € 2.350€	<b>15.03. - 22.03.2025</b> 2.008 € 2.350€	<b>22.03. - 29.03.2025</b> 2.008 € 2.350€	<b>29.03. - 05.04.2025</b> 2.008 € 2.350€
<b>05.04. - 12.04.2025</b> 2.136 € 2.500€	<b>12.04. - 19.04.2025</b> 2.136 € 2.500€	<b>19.04. - 26.04.2025</b> 2.136 € 2.500€	<b>26.04. - 03.05.2025</b> 2.136 € 2.500€
<b>03.05. - 10.05.2025</b> 2.136 € 2.500€	<b>10.05. - 17.05.2025</b> 2.136 € 2.500€	<b>17.05. - 24.05.2025</b> 2.307 € 2.700€	<b>24.05. - 31.05.2025</b> 2.307 € 2.700€
<b>31.05. - 07.06.2025</b> Not available	<b>07.06. - 14.06.2025</b> Not available	<b>14.06. - 21.06.2025</b> Not available	<b>21.06. - 28.06.2025</b> Not available
<b>28.06. - 05.07.2025</b> 2.648 € 3.100€	<b>05.07. - 12.07.2025</b> Not available	<b>12.07. - 19.07.2025</b> 2.734 € 3.200€	<b>19.07. - 26.07.2025</b> Not available
<b>26.07. - 02.08.2025</b> 2.819 € 3.300€	<b>02.08. - 09.08.2025</b> 2.819 € 3.300€	<b>09.08. - 16.08.2025</b> 3.075 € 3.600€	<b>16.08. - 23.08.2025</b> Not available
<b>23.08. - 30.08.2025</b> 2.776 € 3.250€	<b>30.08. - 06.09.2025</b> 2.776 € 3.250€		

## PRICE AND AVAILABILITY

Sun Odyssey 380 Philippa (2023)



<b>06.09. - 13.09.2025</b> Not available	<b>13.09. - 20.09.2025</b> 2.734 € <del>3.200€</del>	<b>20.09. - 27.09.2025</b> 2.734 € <del>3.200€</del>	<b>27.09. - 04.10.2025</b> Not available
<b>04.10. - 11.10.2025</b> 2.008 € <del>2.350€</del>	<b>11.10. - 18.10.2025</b> 2.008 € <del>2.350€</del>	<b>18.10. - 25.10.2025</b> 2.008 € <del>2.350€</del>	<b>25.10. - 01.11.2025</b> 2.008 € <del>2.350€</del>
<b>01.11. - 08.11.2025</b> 2.008 € <del>2.350€</del>	<b>08.11. - 15.11.2025</b> 2.008 € <del>2.350€</del>	<b>15.11. - 22.11.2025</b> 2.008 € <del>2.350€</del>	<b>22.11. - 29.11.2025</b> 2.008 € <del>2.350€</del>
<b>29.11. - 06.12.2025</b> 2.008 € <del>2.350€</del>	<b>06.12. - 13.12.2025</b> 2.008 € <del>2.350€</del>	<b>13.12. - 20.12.2025</b> 2.008 € <del>2.350€</del>	<b>20.12. - 27.12.2025</b> 2.008 € <del>2.350€</del>