

# SUNREEF 60

Sinata (2019)



Pollen Maritime AS • Martin Linges Vei 25 • Fornebu • Norway

Phone: +47 41 197 474

E-mail: [booking@holiday-yacht-charter.com](mailto:booking@holiday-yacht-charter.com)

Web: [holiday-yacht-charter.com](http://holiday-yacht-charter.com)

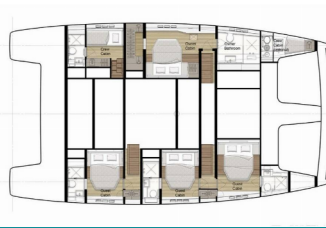
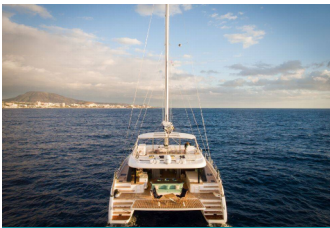

Yacht Base	Marina Frapa, Rogoznica, Croatia
Yacht ID	11602
Yacht Brands	Sunreef Yachts
Yacht Name	Sinata
Production Year	2019
Length	18.30 M
Cabins	4 + 2
Berths	9 + 3
WC/Shower	4 + 2

**COMFORT:** Cockpit cushions

**DECK:** Anchor with chain, Bathing platform, Bilge pump - Mechanic, Bimini top, Boat hook, Bosun's chair (Safe seat) (boatswain's chair), Cockpit fridge, Cockpit/stern, outside shower, Deck brush, Dinghy, Electric anchor windlass, Fenders, Flybridge, Fuel funnel, Gangway, Hard Top Bimini, Outboard engine, Plastic bucket, Round/globular fender, Spare anchor (Reserve, Auxiliary anchor), Sponge, Sprayhood, Swimming ladder, Teak cockpit, Teak deck, Water hose, Winch handles

**ENTERTAINMENT:** Fishing equipment, Indoor speakers, Kayak, Kneeboard, Outdoor speakers, Snorkeling equipment, Stand up paddle (SUP), TV, Wakeboard, Water skis, Wi-Fi Internet

**GALLEY:** Dishwasher, Freezer, Ice maker, Oven, Refrigerator

**INTERIOR:** Coolbox , Electric toilet, Hair dryer, Iron, Salon table, Washer/dryer, Yacht documents

**NAVIGATION:** Bow thruster, Compass, CRO flag, Hand bearing compass, Radar, Radar reflector, Tridata

**SAFETY:** Bilge alarm, Emergency tiller, Fire axe, Fire extinguisher , First aid kit , Fog horn, Horseshoe lifebuoy, Life belts (Safety harness), Life jackets, Liferaft , Padlock, Safety equipment, Set of tools , Torch, Wire (shroud) cutter

**SAILS:** Lazy bag, Lazy jacks

**YACHT ELECTRICS:** Air Conditioning, Bilge pump - Electric, Generator, Heating, Pump, Shore connection 220 V, USB sockets, Watermaker - desalinator

## PRICE AND AVAILABILITY

Sunreef 60 Sinata (2019)



<b>04.01. - 11.01.2025</b> 15.176 € <del>15.975 €</del>	<b>11.01. - 18.01.2025</b> 15.176 € <del>15.975 €</del>	<b>18.01. - 25.01.2025</b> 15.176 € <del>15.975 €</del>	<b>25.01. - 01.02.2025</b> 15.176 € <del>15.975 €</del>
<b>01.02. - 08.02.2025</b> 15.176 € <del>15.975 €</del>	<b>08.02. - 15.02.2025</b> 15.176 € <del>15.975 €</del>	<b>15.02. - 22.02.2025</b> 15.176 € <del>15.975 €</del>	<b>22.02. - 01.03.2025</b> 15.176 € <del>15.975 €</del>
<b>01.03. - 08.03.2025</b> 15.176 € <del>15.975 €</del>	<b>08.03. - 15.03.2025</b> 15.176 € <del>15.975 €</del>	<b>15.03. - 22.03.2025</b> 15.176 € <del>15.975 €</del>	<b>22.03. - 29.03.2025</b> 15.176 € <del>15.975 €</del>
<b>29.03. - 05.04.2025</b> 15.176 € <del>15.975 €</del>	<b>05.04. - 12.04.2025</b> 15.176 € <del>15.975 €</del>	<b>12.04. - 19.04.2025</b> 15.176 € <del>15.975 €</del>	<b>23.04. - 30.04.2025</b> Not available
<b>03.05. - 10.05.2025</b> 21.921 € <del>23.075 €</del>	<b>10.05. - 17.05.2025</b> 21.921 € <del>23.075 €</del>	<b>17.05. - 24.05.2025</b> 21.921 € <del>23.075 €</del>	<b>24.05. - 31.05.2025</b> 21.921 € <del>23.075 €</del>
<b>31.05. - 07.06.2025</b> 33.725 € <del>35.500 €</del>	<b>07.06. - 14.06.2025</b> 33.725 € <del>35.500 €</del>	<b>18.06. - 25.06.2025</b> Not available	<b>04.07. - 11.07.2025</b> Not available
<b>12.07. - 19.07.2025</b> 37.050 € <del>39.000 €</del>	<b>19.07. - 26.07.2025</b> 37.050 € <del>39.000 €</del>	<b>26.07. - 02.08.2025</b> 37.050 € <del>39.000 €</del>	

## PRICE AND AVAILABILITY

Sunreef 60 Sinata (2019)



<b>02.08. - 09.08.2025</b> 37.050 € <del>39.000 €</del>	<b>09.08. - 16.08.2025</b> 37.050 € <del>39.000 €</del>	<b>16.08. - 23.08.2025</b> 37.050 € <del>39.000 €</del>	<b>29.08. - 05.09.2025</b> Not available
<b>06.09. - 13.09.2025</b> Not available	<b>14.09. - 21.09.2025</b> Not available	<b>27.09. - 04.10.2025</b> 23.608 € <del>24.850 €</del>	<b>04.10. - 11.10.2025</b> 16.525 € <del>17.395 €</del>
<b>11.10. - 18.10.2025</b> 16.525 € <del>17.395 €</del>	<b>18.10. - 25.10.2025</b> 16.525 € <del>17.395 €</del>	<b>25.10. - 01.11.2025</b> 16.525 € <del>17.395 €</del>	<b>01.11. - 08.11.2025</b> 16.525 € <del>17.395 €</del>
<b>08.11. - 15.11.2025</b> 16.525 € <del>17.395 €</del>	<b>15.11. - 22.11.2025</b> 16.525 € <del>17.395 €</del>	<b>22.11. - 29.11.2025</b> 16.525 € <del>17.395 €</del>	<b>29.11. - 06.12.2025</b> 16.525 € <del>17.395 €</del>
<b>06.12. - 13.12.2025</b> 16.525 € <del>17.395 €</del>	<b>13.12. - 20.12.2025</b> 16.525 € <del>17.395 €</del>	<b>20.12. - 27.12.2025</b> 16.525 € <del>17.395 €</del>	